



www.pelice-expo.com

# PANEL & ENGINEERED LUMBER INTERNATIONAL CONFERENCE & EXPO

## PanelWorld

VENEER • PLYWOOD • COMPOSITES • ENGINEERED WOOD PRODUCTS • LAMINATES

April 13-14, 2018

### Omni Hotel at CNN Center Atlanta, Georgia

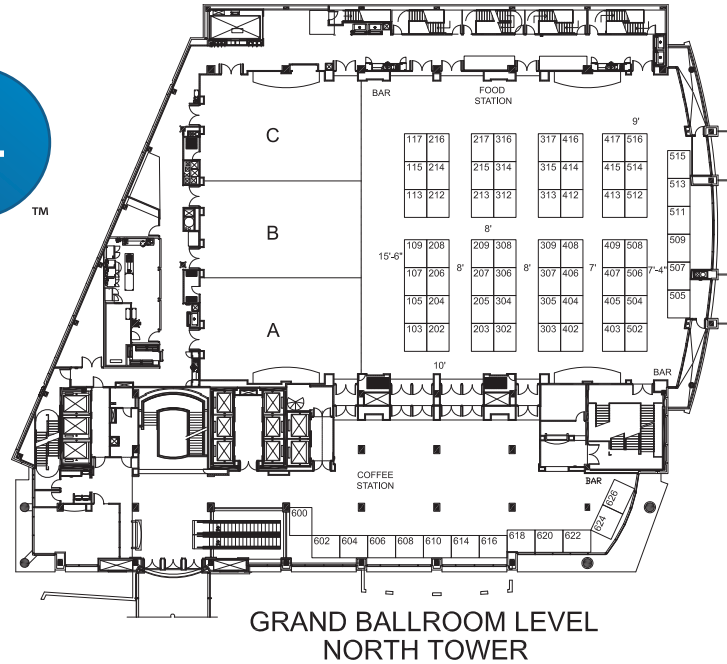

Please make 3 booth location choices

1st choice \_\_\_\_\_ 2nd choice \_\_\_\_\_ 3rd choice \_\_\_\_\_

## EXHIBITOR SPONSORSHIP FORM

COMPANY SIGN SHOULD READ: \_\_\_\_\_

PHONE \_\_\_\_\_

CONTACT NAME \_\_\_\_\_

EMAIL \_\_\_\_\_

ADDRESS \_\_\_\_\_

CONTACT AT SHOW \_\_\_\_\_

CITY/STATE/ZIP \_\_\_\_\_

CELL PHONE \_\_\_\_\_

**GOLD SPONSOR:** 8x10 exhibit booth; electricity; wireless internet; 4x4 Registration Deal (four conference registrations to be used by your company personnel and four registrations to be given to your customers/clients); 2 Omni Hotel Rooms x 2 nights; one-page technical article submitted by your company for publication in Panel World magazine; company logo on sponsorship signage at first day evening reception, as well as on promotional materials leading up to the event and in conference program and on conference web site..... **Cost \$8,750**

**SILVER SPONSOR:** 8x10 exhibit booth; electricity; wireless internet; 2x2 Registration Deal (two conference registrations to be used by your company personnel and two registrations to be given to your customers/clients); 2 Omni Hotel Rooms x 2 nights; a half-page technical article submitted by your company for publication in Panel World magazine; company logo on sponsorship signage for first day lunch; as well as on promotional materials leading up to the event and in conference program and on conference web site..... **Cost \$5,750**

**BRONZE SPONSOR:** 8x10 exhibit booth; electricity; wireless internet; 1x1 Registration Deal (one conference registration to be used by your company personnel and one registration to be given to your customer/client); 1 Omni Hotel room x 2 nights; company logo on sponsorship signage at first day breakfast; as well as on promotional materials leading up to the event and in conference program and on conference web site..... **Cost \$3,750**

All sponsorship packages include 8x10 booth with (1) 8' back drape, (2) 3' side drapes, (1) 6' skirted table, (2) side chairs, (1) ID sign, (1) waste basket, (1) electrical outlet 110v, wireless internet

Please mail, e-mail or fax exhibitor sponsorship form to: Dianne Sullivan, Panel World, PO Box 2268, Montgomery, Alabama 36102-2268. Phone 334-834-1170, ext. 127. Fax 334-387-2383. E-mail: Dianne@hattonbrown.com. For additional information contact Fred Kurpiel, Phone: 678-642-1238, Email: fredkurpiel@aol.com

PRINT NAME \_\_\_\_\_

EMAIL \_\_\_\_\_

AUTHORIZING SIGNATURE - EXHIBITOR REPRESENTATIVE \_\_\_\_\_

DATE \_\_\_\_\_

*This form represents an official space reservation form between Panel & Engineered Lumber International Conference & Expo and the Exhibitor company, with contract, rules/regulations and invoice to follow.*

[www.pelice-expo.com](http://www.pelice-expo.com)

# BIOENERGY / PELICE

April 11-12, 2018

April 13-14, 2018

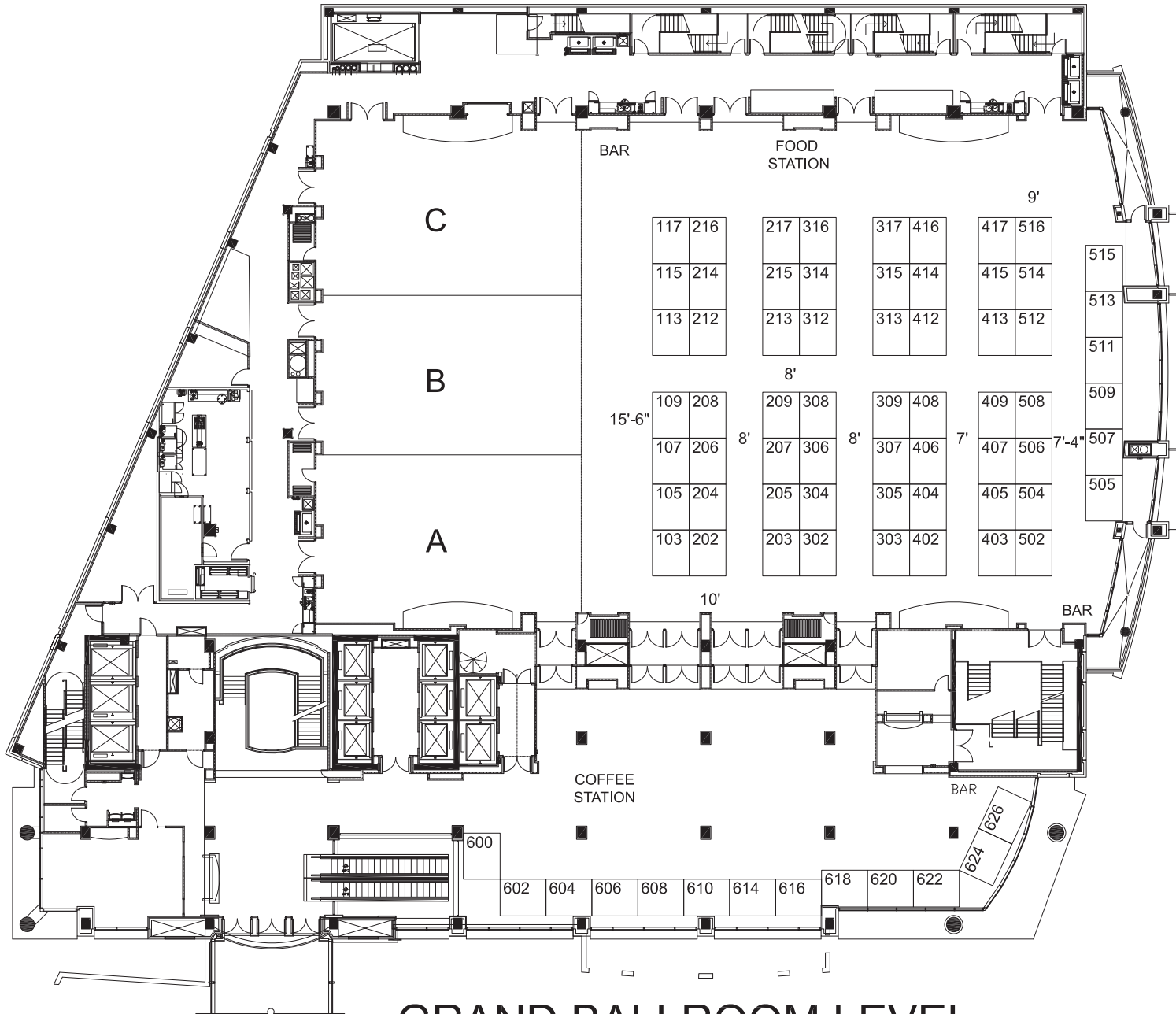

## GRAND BALLROOM LEVEL NORTH TOWER